



Construction Tool Steels and Accessories

Contents

Pavement Breaker Steels, Digger Steels, and Accessories	3
Jackhammer and Rockdrill Rods and Bits	9
Rivet Buster Steels and Accessories . .	12
Chipping Hammer Steels and Accessories	14
Pneumatic Hammer Chisels	19
Backfill Tamper and Sand Rammer Butts	21
Scaler and Needle Scaler Steels	22
Cross-reference Tables	27
Safety	33
Warranty	34

Strong products from a strong company

Ingersoll Rand offers a complete line of construction tool steels and accessories for countless applications. Our construction heritage dates back to 1871 with the invention of the world's first rockdrill. Drawing on our long and successful history in the construction industry, we use top-grade materials to manufacture a line of tough, durable products that are versatile enough to be used in virtually every tool brand.



As a full-line equipment and tool provider, Ingersoll Rand also offers such service and maintenance tools as impact wrenches, surface preparation tools, pullers, hoists, winches for material handling, and a complete offering of parts and accessories to complement each tool product. With our unique heritage, proven performance, and strong customer support, we're breaking new ground for jobsite solutions. For more details, go to irtools.com or contact an Ingersoll Rand representative at (866) IR4-TOOL.





Pavement Breaker Steels, Digger Steels, and Accessories

Choose from a complete line of tool steels for your pavement breaker, with products for many applications including concrete, asphalt, excavation, and general demolition.

Pavement Breaker and Digger Steels

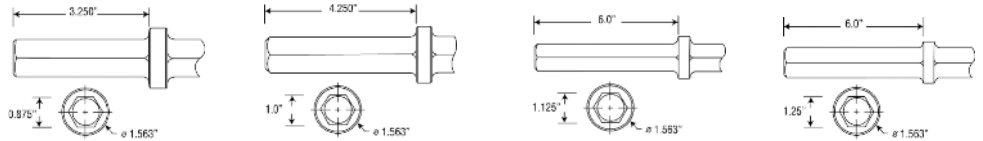

Moil Point



General demolition

Hex Shank Size	7/8" x 3-1/4"			1" x 4-1/4"			1-1/8" x 6"			1-1/4" x 6"		
Length Under Collar	Part Number	Weight lb	Box Quantity	Part Number	Weight lb	Box Quantity	Part Number	Weight lb	Box Quantity	Part Number	Weight lb	Box Quantity
MOIL POINT — STANDARD-DUTY												
14"	50050269	3.25	10	50050368	4.5	10	50050475	6	10	50055680	7.5	10
18"	50050277	4	10	50050376	5.5	5	50055524	7.25	5	50055698	9	10
24"	50050285	5.25	1	50050392	6.75	1	50055540	9.5	1	50055714	11.25	1
36"	51305860	7.5	1	45512563	10	1	50055565	13.25	1	50055730	15.75	1
48"	45512621	9.75	1	45512571	13	1	50055573	17	1	50055748	20.5	1
60"	45512639	12	1	45512589	15.75	1	50055581	20.5	1	50055755	25	1
72"	45512647	14.25	1	45512597	18.75	1	50055599	24	1	50198993	29.5	1
84"				45512605	21.75	1	45512514	28	1	45512688	34	1
96"				45512613	24.5	1	45512522	31.75	1	45512696	38.75	1
120"				45512530	30.5	1	45512480	39.75	1	45512654	48.5	1
144"				45512548	36.75	1	45512498	47.5	1	45512662	58.25	1
168"				45512555	42.75	1	45512506	55.5	1	45512670	68	1
MOIL POINT — SUPER-DUTY												
11-1/4"	22041495	3.5	5	22041057	4	5	22041073	6.5	5	22041099	7.5	5
14-1/4"	22041602	3.75	5	22041065	5.25	5	22041081	6.75	5	22041107	8	5

Pavement Breaker and Digger Steels

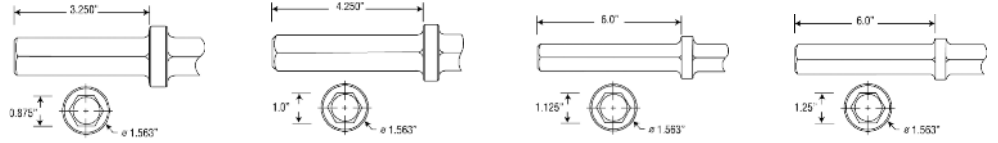

1" Narrow Chisel

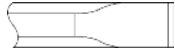

General demolition

Hex Shank Size	7/8" x 3-1/4"			1" x 4-1/4"			1-1/8" x 6"			1-1/4" x 6"		
Length Under Collar	Part Number	Weight lb	Box Quantity	Part Number	Weight lb	Box Quantity	Part Number	Weight lb	Box Quantity	Part Number	Weight lb	Box Quantity
1" NARROW CHISEL — STANDARD-DUTY												
14"	50199207	3.25	10	50197805	4.5	5	50197904	6	10	50196385	7.5	10
18"	50199215	4	10	50197821	5.5	5	50197912	7.25	5	50196401	9	5
24"	50199223	5.25	1	45510245	6.75	1	50197938	9.5	1	50196419	11.25	1
36"	45510682	7.5	1	45510252	10	1	51298107	13.25	1	51299477	15.75	1
48"	45510690	9.75	1	45510260	13	1	50197979	17	1	51299485	20.5	1
60"	45510708	12	1	45510278	15.75	1	50197987	20.5	1	51299048	25	1
72"	45510716	14.25	1	45510286	18.75	1	50197995	24	1	51299493	29.5	1
84"				45510294	21.75	1	45510385	28	1	45509965	34	1
96"				45510302	24.5	1	45510393	31.75	1	45509973	38.75	1
120"				45510211	30.5	1	45510401	39.75	1	45509932	48.5	1
144"				45510229	36.75	1	45510369	47.5	1	45509940	58	1
168"				45510237	42.75	1	45510377	55.5	1	45509957	67.75	1
1" NARROW CHISEL — SUPER-DUTY												
11-1/4"	22041503	3.5	5	22041115	4	5	22041131	6.5	5	22041156	7.5	5
14-1/4"	22041610	3.75	5	22041123	5.25	5	22041149	6.75	5	22041164	8	5

3" Chisel



Concrete demolition and asphalt cutting

Hex Shank Size	7/8" x 3-1/4"			1" x 4-1/4"			1-1/8" x 6"			1-1/4" x 6"		
Length Under Collar	Part Number	Weight lb	Box Quantity	Part Number	Weight lb	Box Quantity	Part Number	Weight lb	Box Quantity	Part Number	Weight lb	Box Quantity
3" CHISEL												
14"	50195288	3.25	5	50195320	4.5	10	50114883	6	10	50193879	7.5	10
18"	50195296	4	5	50195338	5.5	10	50193754	7.25	5	50193887	9	5
24"	45510542	5.5	1	50195353	6.75	1	50193747	9.75	1	50193903	12.25	1
36"	45510559	8	1	50195361	10	1	45510500	13.5	1	45510484	16.75	1
48"	45510567	10	1	50195379	12.75	1	45510518	17.25	1	50193937	21.25	1
60"	45510575	12.25	1	45510476	16.5	1	45510526	21	1	45510492	26	1
72"	45510583	14	1	51304574	19.25	1	45510534	24.75	1	50191790	30	1

Pavement Breaker and Digger Steels

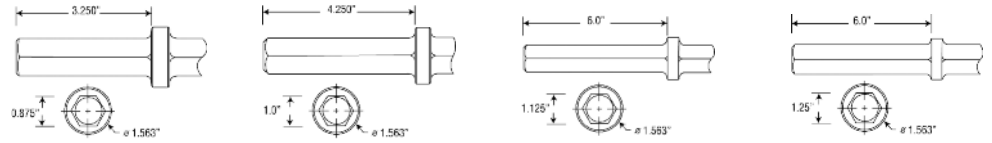

1-1/2" Super Cut Chisel



Specially designed for breaking concrete

Hex Shank Size		7/8" x 3-1/4"			1" x 4-1/4"			1-1/8" x 6"			1-1/4" x 6"		
Length Under Collar	Part Number	Weight lb	Box Quantity	Part Number	Weight lb	Box Quantity	Part Number	Weight lb	Box Quantity	Part Number	Weight lb	Box Quantity	
1-1/2" SUPER CUT CHISEL													
16"				22040463	4.5	5	22040471	8	5	22040489	9.25	5	

3-3/4" Combo Cutter

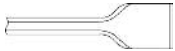

Great for manhole reconstruction

Hex Shank Size		7/8" x 3-1/4"			1" x 4-1/4"			1-1/8" x 6"			1-1/4" x 6"		
Length Under Collar	Part Number	Weight lb	Box Quantity	Part Number	Weight lb	Box Quantity	Part Number	Weight lb	Box Quantity	Part Number	Weight lb	Box Quantity	
3-3/4" COMBO CUTTER													
12"							22040612	8.5	5	22040620	9.5	5	

5" Asphalt Cutter



Asphalt cutting and removal

Hex Shank Size		7/8" x 3-1/4"			1" x 4-1/4"			1-1/8" x 6"			1-1/4" x 6"		
Length Under Collar	Part Number	Weight lb	Box Quantity	Part Number	Weight lb	Box Quantity	Part Number	Weight lb	Box Quantity	Part Number	Weight lb	Box Quantity	
5" ASPHALT CUTTER													
12"	22040935	6.75	5	50190404	7.25	5	50185982	8.5	5	50185990	9.25	5	

5-1/2" Clay Spade



Trench digging and trimming

Hex Shank Size		7/8" x 3-1/4"			1" x 4-1/4"			1-1/8" x 6"			1-1/4" x 6"		
Length Under Collar	Part Number	Weight lb	Box Quantity	Part Number	Weight lb	Box Quantity	Part Number	Weight lb	Box Quantity	Part Number	Weight lb	Box Quantity	
5-1/2" CLAY SPADE													
16"	50189596	7	5	50189554	7.25	5	50189562	8.5	5	50189570	11	5	

3" Digging Chisel



Digging and deeper asphalt cutting

Hex Shank Size		7/8" x 3-1/4"			1" x 4-1/4"			1-1/8" x 6"			1-1/4" x 6"		
Length Under Collar	Part Number	Weight lb	Box Quantity	Part Number	Weight lb	Box Quantity	Part Number	Weight lb	Box Quantity	Part Number	Weight lb	Box Quantity	
3" DIGGING CHISEL													
16"	22040968	7.5	5	22040976	8	5	22040984	10	5	50186014	11.5	5	

Pavement Breaker and Digger Steels

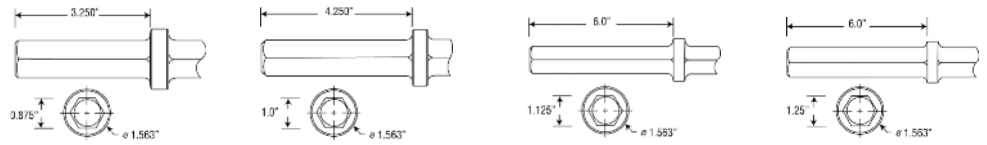

Frost Wedge



Used for breaking frozen ground

Hex Shank Size		7/8" x 3-1/4"			1" x 4-1/4"			1-1/8" x 6"			1-1/4" x 6"		
Length Under Collar	Part Number	Weight lb	Box Quantity	Part Number	Weight lb	Box Quantity	Part Number	Weight lb	Box Quantity	Part Number	Weight lb	Box Quantity	
FROST WEDGE													
16-1/2"	FW40810	7	1	FW40820	10	1	FW40830	13	1	FW40840	18	1	

Bushing Tool

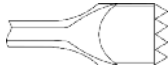

Concrete surface removal or roughing

Hex Shank Size		7/8" x 3-1/4"			1" x 4-1/4"			1-1/8" x 6"			1-1/4" x 6"		
Length Under Collar	Part Number	Weight lb	Box Quantity	Part Number	Weight lb	Box Quantity	Part Number	Weight lb	Box Quantity	Part Number	Weight lb	Box Quantity	
BUSHING TOOL													
9"	BT41310	5	1	BT41320	6.5	1	BT41330	7	1	BT41340	7.25	1	

Pavement Breaker and Digger Accessories

Concrete Breaker



Breaking up concrete; driven into drilled hole

Hex Shank Size		7/8" x 3-1/4"			1" x 4-1/4"			1-1/8" x 6"			1-1/4" x 6"		
Length Under Collar	Part Number	Weight lb	Box Quantity	Part Number	Weight lb	Box Quantity	Part Number	Weight lb	Box Quantity	Part Number	Weight lb	Box Quantity	
CONCRETE BREAKER													
14-1/2"							CB40960	11.25	1	CB40970	12.25	1	

1" Pipe Driver



Driving steel pipe up to 1" O.D.

Hex Shank Size		7/8" x 3-1/4"			1" x 4-1/4"			1-1/8" x 6"			1-1/4" x 6"		
Length Under Collar	Part Number	Weight lb	Box Quantity	Part Number	Weight lb	Box Quantity	Part Number	Weight lb	Box Quantity	Part Number	Weight lb	Box Quantity	
1" PIPE DRIVER													
11"							22040505	5	1	22040513	6.5	1	

1-1/2" Pipe Driver

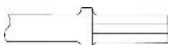

Driving steel pipe up to 1-1/2" O.D.

Hex Shank Size		7/8" x 3-1/4"			1" x 4-1/4"			1-1/8" x 6"			1-1/4" x 6"		
Length Under Collar	Part Number	Weight lb	Box Quantity	Part Number	Weight lb	Box Quantity	Part Number	Weight lb	Box Quantity	Part Number	Weight lb	Box Quantity	
1-1/2" PIPE DRIVER													
11"							22040547	7	1	22040554	7.5	1	

Pavement Breaker and Digger Accessories

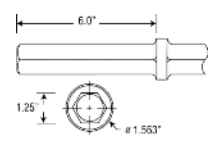
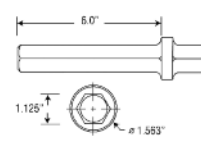
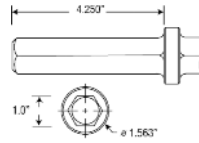
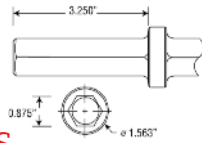

Ground Rod Driver



Driving steel rod up
to 1" O.D.

Hex Shank Size		7/8" x 3-1/4"			1" x 4-1/4"			1-1/8" x 6"			1-1/4" x 6"		
Length	Part	Weight	Box	Part	Weight	Box	Part	Weight	Box	Part	Weight	Box	
Under Collar	Number	Lb	Quantity	Number	Lb	Quantity	Number	Lb	Quantity	Number	Lb	Quantity	
GROUND ROD DRIVER													
9"				22040588	5.25	5	22040596	6.75	5	22040604	7.25	5	

3-piece Sign Post Driver

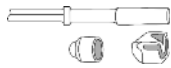

Includes shank, post block,
and 3-1/2" driver

Hex Shank Size		7/8" x 3-1/4"			1" x 4-1/4"			1-1/8" x 6"			1-1/4" x 6"		
Length	Part	Weight	Box	Part	Weight	Box	Part	Weight	Box	Part	Weight	Box	
Under Collar	Number	Lb	Quantity	Number	Lb	Quantity	Number	Lb	Quantity	Number	Lb	Quantity	
3-PIECE SIGN POST DRIVER													
7-3/4"	22040778	5	1	22040943	5.25	1	22041008	5.25	1	22041016	6	1	

Detachable Shank



Used with tent stake
drivers and tamping pads

Hex Shank Size		7/8" x 3-1/4"			1" x 4-1/4"			1-1/8" x 6"			1-1/4" x 6"		
Length	Part	Weight	Box	Part	Weight	Box	Part	Weight	Box	Part	Weight	Box	
Under Collar	Number	Lb	Quantity	Number	Lb	Quantity	Number	Lb	Quantity	Number	Lb	Quantity	
DETACHABLE SHANK													
9"	22040927	4	1	50187830	4.5	1	50187848	5.25	1	50187855	6	1	

2" Tent Stake Driver



Used with detachable shank

Hex Shank Size		7/8" x 3-1/4"			1" x 4-1/4"			1-1/8" x 6"			1-1/4" x 6"		
Length	Part	Weight	Box	Part	Weight	Box	Part	Weight	Box	Part	Weight	Box	
Under Collar	Number	Lb	Quantity	Number	Lb	Quantity	Number	Lb	Quantity	Number	Lb	Quantity	
2" TENT STAKE DRIVER													
N/A	22040638	3.5	1	22040638	3.5	1	22040638	3.5	1	22040638	3.5	1	

2-1/2" Tent Stake Driver



Used with detachable shank

Hex Shank Size		7/8" x 3-1/4"			1" x 4-1/4"			1-1/8" x 6"			1-1/4" x 6"		
Length	Part	Weight	Box	Part	Weight	Box	Part	Weight	Box	Part	Weight	Box	
Under Collar	Number	Lb	Quantity	Number	Lb	Quantity	Number	Lb	Quantity	Number	Lb	Quantity	
2-1/2" TENT STAKE DRIVER													
N/A	22040646	4	1	22040646	4	1	22040646	4	1	22040646	4	1	

Pavement Breaker and Digger Accessories

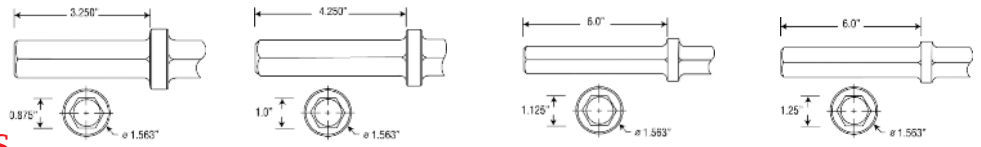

6" Tamping Pad Square



Tamping and backfilling; used with detachable shank

Hex Shank Size	7/8" x 3-1/4"			1" x 4-1/4"			1-1/8" x 6"			1-1/4" x 6"		
Length Under Collar	Part Number	Weight lb	Box Quantity	Part Number	Weight lb	Box Quantity	Part Number	Weight lb	Box Quantity	Part Number	Weight lb	Box Quantity
6" TAMPING PAD SQUARE												
N/A	51305894	10.5	1	51305894	10.5	1	51305894	10.5	1	51305894	10.5	1

8" Tamping Pad Square



Tamping and backfilling; used with detachable shank

Hex Shank Size	7/8" x 3-1/4"			1" x 4-1/4"			1-1/8" x 6"			1-1/4" x 6"		
Length Under Collar	Part Number	Weight lb	Box Quantity	Part Number	Weight lb	Box Quantity	Part Number	Weight lb	Box Quantity	Part Number	Weight lb	Box Quantity
8" TAMPING PAD SQUARE												
N/A	50187897	14.5	5	50187897	14.5	5	50187897	14.5	5	50187897	14.5	5

Tie Tamper Steels

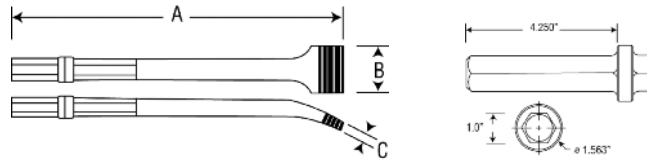

Plain-face Tie Tamper Steel

Part Number	Dimensions in			Weight lb	Box Quantity	Description
	A	B	C			
PLAIN-FACE TIE TAMPER STEEL						
45512720	24"	3"	3/8"	5.25	1	For spot-tamping and low lifts
45512738	24"	3"	5/8"	6.5	1	For rock ballast of 29 mesh or larger
45512746	24"	3"	7/8"	8	1	For small rock ballast, gravel, and slag
45512712	24"	3"	3/4"	7.25	1	For dirt, cinder, gravel, sand, or chat ballast
45512704	24"	3"	1-1/8"	8	1	For dirt, cinder, gravel, sand, or chat ballast

Tooth-face Tie Tamper Steel

TOOTH-FACE TIE TAMPER STEEL						
45513231	24"	3"	5/8"	7.5	1	For stone ballast



Jackhammer and Rockdrill Rods and Bits

Our carbide-tipped drill steels are available in diameters from 5/8" to 1-5/8" to meet all your drilling needs. Our complete range of shank sizes lets you use Ingersoll Rand drill steels with virtually any jackhammer or rockdrill.

All jackhammer rods and bits are sold as single units (no required box quantities).

Jackhammer Rods

Hexagon Shank Whirlibits Carbide-tipped Drill Steel

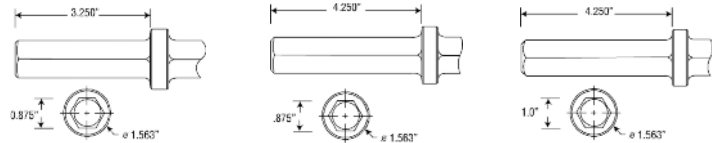
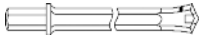

Hex Shank Size		7/8" x 3-1/4"		7/8" x 4-1/4"		1" x 4-1/4"		
Diameter	Depth	Length Under Collar	Part Number	Weight lb	Part Number	Weight lb	Part Number	Weight lb
HEXAGON SHANK WHIRLIBITS CARBIDE-TIPPED DRILL STEEL								
5/8"	6"	9"	WB5869	1.5	WBA5869	1.75		
5/8"	9"	12"	WB58912	1.75	WBA58912	2		
5/8"	15"	18"	WB581518	2	WBA581518	2.25		
5/8"	21"	24"	WB582124	2.5	WBA582124	2.75		
5/8"	27"	30"	WB582730	3	WBA582730	3.25		
3/4"	6"	9"	WB3469	1.75	WBA3469	2		
3/4"	9"	12"	WB34912	2	WBA34912	2.25	WBC34912	2.5
3/4"	15"	18"	WB341518	2.5	WBA341518	2.75	WBC341518	3
3/4"	21"	24"	WB342124	3	WBA342124	3.25	WBC342124	3.5
3/4"	27"	30"	WB342730	3.5	WBA342730	3.75	WBC342730	4
3/4"	33"	36"	WB343336	3.75	WBA343336	4		
3/4"	45"	48"	WB344548	4.25	WBA344548	4.5		
7/8"	6"	9"	WB7869	2	WBA7869	2.25		
7/8"	9"	12"	WB78912	2.5	WBA78912	2.75	WBC78912	2.5
7/8"	15"	18"	WB781518	3	WBA781518	3.25	WBC781518	3.25
7/8"	21"	24"	WB782124	3.75	WBA782124	4	WBC782124	4
7/8"	27"	30"	WB782730	4.5	WBA782730	4.75	WBC782730	4.5
7/8"	33"	36"	WB783336	5	WBA783336	5.25	WBC783336	5.5
7/8"	45"	48"	WB784548	6.25	WBA784548	6.5		

Jackhammer Rods

Hexagon Shank Whirlibits Carbide-tipped Drill Steel

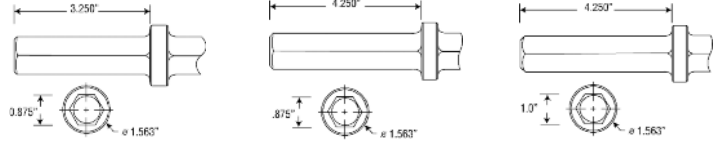
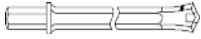

Hex Shank Size			7/8" x 3-1/4"		7/8" x 4-1/4"		1" x 4-1/4"	
Diameter	Depth	Length Under Collar	Part Number	Weight lb	Part Number	Weight lb	Part Number	Weight lb
HEXAGON SHANK WHIRLIBITS CARBIDE-TIPPED DRILL STEEL								
1"	9"	12"	WB1912	2.75	WBA1912	3	WBC1912	3
1"	15"	18"	WB11518	3.5	WBA11518	3.75	WBC11518	4
1"	21"	24"	WB12124	4.25	WBA12124	4.5	WBC12124	5
1"	27"	30"	WB12730	5.25	WBA12730	5.5	WBC12730	5.75
1"	33"	36"	WB13336	6	WBA13336	6.25		
1"	45"	48"	WB14548	7.5	WBA14548	7.75		
1-1/8"	9"	12"	WB118912	3	WBA118912	3.25	WBC118912	3.75
1-1/8"	15"	18"	WB1181518	4	WBA1181518	4.25	WBC1181518	4.5
1-1/8"	21"	24"	WB1182124	5	WBA1182124	5.25	WBC1182124	5.5
1-1/8"	27"	30"	WB1182730	6	WBA1182730	6.25	WBC1182730	6.75
1-1/8"	33"	36"	WB1183336	6.75	WBA1183336	7	WBC1183336	7.75
1-1/8"	45"	48"	WB1184548	8.75	WBA1184548	9		
1-1/4"	9"	12"	WB114912	3	WBA114912	3.25	WBC114912	4.25
1-1/4"	15"	18"	WB1141518	4	WBA1141518	4.25	WBC1141518	5.5
1-1/4"	21"	24"	WB1142124	5	WBA1142124	5.25	WBC1142124	6.75
1-1/4"	27"	30"	WB1142730	6	WBA1142730	6.25	WBC1142730	8
1-1/4"	33"	36"	WB1143336	7	WBA1143336	7.25		
1-1/4"	45"	48"	WB1144548	8.75	WBA1144548	9	WBC1144548	11.5
1-3/8"	9"	12"	WB138912	3.25	WBA138912	3.5	WBC138912	4.25
1-3/8"	15"	18"	WB1381518	4	WBA1381518	4.25	WBC1381518	5.5
1-3/8"	21"	24"	WB1382124	5.25	WBA1382124	5.5	WBC1382124	6.5
1-3/8"	27"	30"	WB1382730	6.25	WBA1382730	6.5	WBC1382730	8
1-3/8"	45"	48"	WB1384548	7.25	WBA1384548	9.25		
1-1/2"	9"	12"	WB112912	3.25	WBA112912	3.5	WBC112912	4
1-1/2"	15"	18"	WB1121518	4.25	WBA1121518	4.5	WBC1121518	5.5
1-1/2"	21"	24"	WB1122124	5.25	WBA1122124	5.5	WBC1122124	6.75
1-1/2"	27"	30"	WB1122730	6.25	WBA1122730	6.5	WBC1122730	8
1-1/2"	45"	48"	WB1124548	9				
1-5/8"	15"	18"	WB1581518	4	WBA1581518	4.25		
1-5/8"	21"	24"	WB11582124	5.5	WBA11582124	5.75	WBC1582124	7

Jackhammer Rods

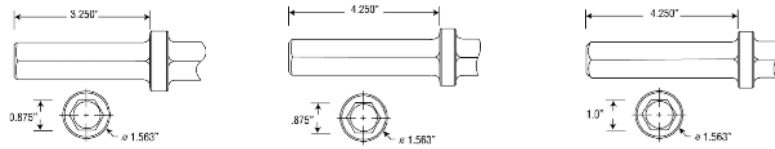

"H" Thread Rod



Hex Shank Size		7/8" x 3-1/4"		7/8" x 4-1/4"		1" x 4-1/4"	
Length Under Collar	Part Number	Weight lb	Part Number	Weight lb	Part Number	Weight lb	Part Number
"H" THREAD ROD							
12"	45509585	3	51242006	3.25	50713023	4	
18"	50283266	4	51242014	4.25	50713031	5	
24"	50283506	5	51233690	5.25	50354596	7	
30"	51305639	6	51242030	6.25	51305704	9	
36"	50712728	7	51234052	7.25	50713049	10	
48"	50283555	9	51234060	9.25	50283183	12	
60"	50712736	11	51242063	12	50713056	15	
72"	50712744	14	50712975	13.25	50283696	18	
96"	50712751	18			50283241	23	
120"	45509593	22			50712132	28	
144"					50712140	33.5	

Jackhammer Bits

"H" Thread Carbide Bit



Bit Size	Single-use Bits		Multi-use Bits	
	Part Number	Weight lb	Part Number	Weight lb
"H" THREAD CARBIDE BIT				
1-3/8"	51248359	0.44	51307155	0.5
1-1/2"	51248367	0.46	51248300	0.6
1-5/8"	51248375	0.56	51248318	0.65
1-3/4"	51248383	0.6	51248326	0.8
1-7/8"	51248391	0.82	51248334	0.9
2"	51248409	0.88	51248342	1.1
2-1/4"			51356723	1.2
2-1/2"			51293017	1.3



Rivet Buster Steels and Accessories

Our jumbo shank rivet buster steels and attachments are ideal for general demolition and steel demolition applications.

Jumbo Shank Rivet Buster Steels

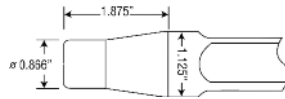

Moil Point



General demolition

Flat Chisel



General demolition

Side-cut Chisel



Steel, rivet cutting

Ripper

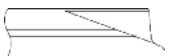

Splitting steel

Length	Part Number	Weight lb	Box Quantity
MOIL POINT			
9"	9001-297-9	2	15
12"	9001-297-12	2.5	15
18"	9001-297-18	3.75	5
24"	9001-297-24	5.5	1
36"	9001-297-36	8	1
FLAT CHISEL			
9"	9001-276-9-1/2	2	15
12"	9001-276-12	2.5	15
18"	9001-276-18	3.75	15
24"	9001-276-24	5.5	1
36"	9001-276-36	8	1
SIDE-CUT CHISEL			
9"	9001-277-9-1/2	2	5
12"	9001-277-12	2.5	5
18"	9001-277-18	3.75	5
24"	9001-277-24	5.5	1
36"	9001-277-36	8	1
RIPPER			
9"	9001-295-9-1/2	2	5
12"	9001-295-12	2.5	5

Backout Punches

Backout Punch



Removing bolts and rivets

Length	Rivet Diameter	Part Number	Weight lb	Box Quantity
BACKOUT PUNCH				
9-1/2"	3/8"	9001-278	2	5
9-1/2"	1/2"	9001-279	2	5
9-1/2"	5/8"	9001-280	2	5
9-1/2"	3/4"	9001-281	2.25	5
9-1/2"	7/8"	9001-282	2.25	5
9-1/2"	1"	9001-283	2.25	5

Rivet Buster Accessories

Retainer



89938443



9001-200

Barrel Threaded (9001, 11001) Part Number	Box Quantity	Barrel Grooved (8001A, 9001A, 11001A) Part Number	Box Quantity
RETAINER			
N/A		89938443	1
9001-200	1	N/A	

Upper Sleeve



9001-220

Lower Sleeve



9001-201

Barrel Threaded (9001, 11001) Part Number	Box Quantity	Barrel Grooved (8001A, 9001A, 11001A) Part Number	Box Quantity
UPPER SLEEVE			
9001-220	1	9001-220	1
LOWER SLEEVE			
9001-201	1	9001-201	1

Bumper



9001-203

Barrel Threaded (9001, 11001) Part Number	Box Quantity	Barrel Grooved (8001A, 9001A, 11001A) Part Number	Box Quantity
BUMPER			
9001-203	1	9001-203	1

Lock Clip



9RB-207

Spring Lock



89938450

Barrel Threaded (9001, 11001) Part Number	Box Quantity	Barrel Grooved (8001A, 9001A, 11001A) Part Number	Box Quantity
LOCK CLIP			
9RB-207	1	N/A	
SPRING LOCK			
N/A		89938450	5

Key



9001-208

Pin



FMD2-667

Barrel Threaded (9001, 11001) Part Number	Box Quantity	Barrel Grooved (8001A, 9001A, 11001A) Part Number	Box Quantity
KEY			
9001-208	1	N/A	
PIN			
FMD2-667	1	N/A	



Chipping Hammer Steels and Accessories

Suitable for a wide range of applications, our chipping hammer steels are available with round or hex shanks and oval or round collars.

Chipping Hammer Steels

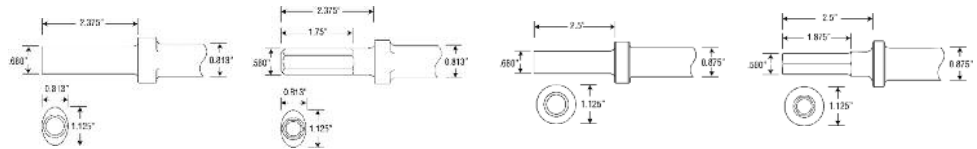

Blank



For making customized points

Length	Round Shank Oval Collar		Hex Shank Oval Collar		Round Shank Round Collar		Hex Shank Round Collar		Weight lb
	Part Number	Box Quantity	Part Number	Box Quantity	Part Number	Box Quantity	Part Number	Box Quantity	
BLANK									
12"	HH1-215-12	5	HH1-214-12	5	H3R-215-12	5	H3R-214-12	5	1.75
18"	HH1-215-18	5	HH1-214-18	5	H3R-215-18	5	H3R-214-18	5	2.75
24"	HH1-215-24	1	HH1-214-24	1	H3R-215-24	1	H3R-214-24	1	3.5
36"	HH1-215-36	1	HH1-214-36	1	H3R-215-36	1	H3R-214-36	1	5.5

1" Flat Chisel



General demolition

Length	Round Shank Oval Collar		Hex Shank Oval Collar		Round Shank Round Collar		Hex Shank Round Collar		Weight lb
	Part Number	Box Quantity	Part Number	Box Quantity	Part Number	Box Quantity	Part Number	Box Quantity	
1" FLAT CHISEL									
9"	HH1-215F-9	10	HH1-214F-9	10	H3R-215F-9	10	H3R-214F-9	10	1.25
12"	HH1-215F-12	15	HH1-214F-12	15	H3R-215F-12	15	H3R-214F-12	15	1.75
18"	HH1-215F-18	15	HH1-214F-18	15	H3R-215F-18	15	H3R-214F-18	10	2.5
24"	HH1-215F-24	5	HH1-214F-24	5	H3R-215F-24	1	H3R-214F-24	5	3
36"	HH1-215F-36	1	HH1-214F-36	1	H3R-215F-36	1	H3R-214F-36	1	5.25
48"	HH1-215F-48	1	HH1-214F-48	1	H3R-215F-48	1	H3R-214F-48	1	6
60"	HH1-215F-60	1	HH1-214F-60	1	H3R-215F-60	1	H3R-214F-60	1	9
72"	HH1-215F-72	1	HH1-214F-72	1	H3R-215F-72	1	H3R-214F-72	1	9.25
84"	HH1-215F-84	1	HH1-214F-84	1	H3R-215F-84	1	H3R-214F-84	1	13.25
96"	HH1-215F-96	1	HH1-214F-96	1	H3R-215F-96	1	H3R-214F-96	1	15.25

Chipping Hammer Steels

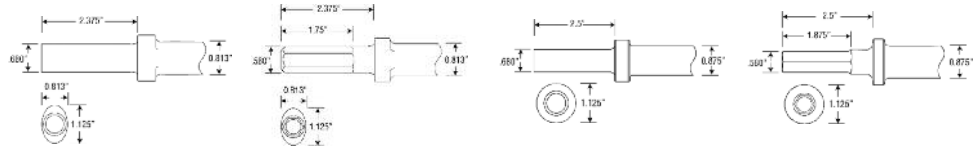

Moil Point



General demolition

	Round Shank Oval Collar		Hex Shank Oval Collar		Round Shank Round Collar		Hex Shank Round Collar		
Length	Part Number	Box Quantity	Part Number	Box Quantity	Part Number	Box Quantity	Part Number	Box Quantity	Weight lb
MOIL POINT									
9"	HH1-215M-9	10	HH1-214M-9	10	H3R-215M-9	10	H3R-214M-9	10	1.25
12"	HH1-215M-12	15	HH1-214M-12	15	H3R-215M-12	5	H3R-214M-12	5	1.75
18"	HH1-215M-18	5	HH1-214M-18	10	H3R-215M-18	5	H3R-214M-18	5	2.5
24"	HH1-215M-24	1	HH1-214M-24	1	H3R-215M-24	5	H3R-214M-24	5	3.5
36"	HH1-215M-36	1	HH1-214M-36	1	H3R-215M-36	5	H3R-214M-36	1	5.25

1-1/2" Scaling Chisel



General demolition

	Round Shank Oval Collar		Hex Shank Oval Collar		Round Shank Round Collar		Hex Shank Round Collar		
Length	Part Number	Box Quantity	Part Number	Box Quantity	Part Number	Box Quantity	Part Number	Box Quantity	Weight lb
1-1/2" SCALING CHISEL									
9"	HH1-215B-9	10	HH1-214B-9	10	H3R-215B-9	10	H3R-214B-9	10	1.5
12"	HH1-215B-12	15	HH1-214B-12	5	H3R-215B-12	5	H3R-214B-12	5	2
18"	HH1-215B-18	5	HH1-214B-18	5	H3R-215B-18	5	H3R-214B-18	5	2.75

2" Scaling Chisel

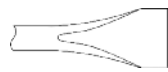

General demolition

	Round Shank Oval Collar		Hex Shank Oval Collar		Round Shank Round Collar		Hex Shank Round Collar		
Length	Part Number	Box Quantity	Part Number	Box Quantity	Part Number	Box Quantity	Part Number	Box Quantity	Weight lb
2" SCALING CHISEL									
9"	HH1-323-9	10	HH1-324-9	10	H3R-423-9	10	H3R-424-9	10	1.25
12"	HH1-323-12	10	HH1-324-12	10	H3R-423-12	10	H3R-424-12	10	2
18"	HH1-323-18	10	HH1-324-18	10	H3R-423-18	10	H3R-424-18	10	2.5
24"	HH1-323-24	5	HH1-324-24	5	H3R-423-24	5	H3R-424-24	5	3.5
36"	HH1-323-36	1	HH1-324-36	1	H3R-423-36	1	H3R-424-36	1	5.25
48"	HH1-323-48	1	HH1-324-48	1	H3R-423-48	1	H3R-424-48	1	7
60"	HH1-323-60	1	HH1-324-60	1	H3R-423-60	1	H3R-424-60	1	9.25
72"	HH1-323-72	1	HH1-324-72	1	H3R-423-72	1	H3R-424-72	1	11
84"	HH1-323-84	1	HH1-324-84	1	H3R-423-84	1	H3R-424-84	1	12.5
96"	HH1-323-96	1	HH1-324-96	1	H3R-423-96	1	H3R-424-96	1	14.5

3" Scaling Chisel

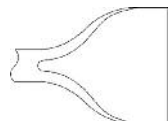

General demolition

	Round Shank Oval Collar		Hex Shank Oval Collar		Round Shank Round Collar		Hex Shank Round Collar		
Length	Part Number	Box Quantity	Part Number	Box Quantity	Part Number	Box Quantity	Part Number	Box Quantity	Weight lb
3" SCALING CHISEL									
12"	HH1-215S-12	10	HH1-214S-12	10	H3R-215S-12	5	H3R-214S-12	5	2

Bushing Tool

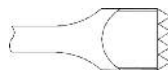

Concrete leveling and roughing

	Round Shank Oval Collar		Hex Shank Oval Collar		Round Shank Round Collar		Hex Shank Round Collar		
Length	Part Number	Box Quantity	Part Number	Box Quantity	Part Number	Box Quantity	Part Number	Box Quantity	Weight lb
BUSHING TOOL									
9"	HH1-215T-9	1	HH1-214T-9	1	H3R-215T-9	5	H3R-214T-9	1	2.5

Don't see what you're looking for?

Call (866) IR4-TOOL

Chipping Hammer Steels

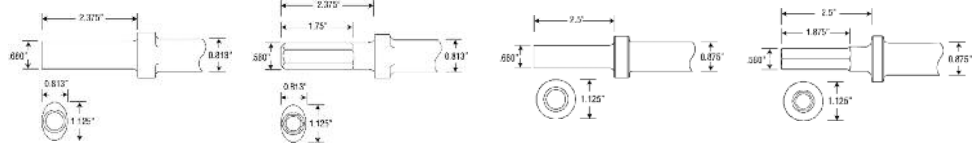

Tooth



Tamping aggregate material

	Round Shank Oval Collar		Hex Shank Oval Collar		Round Shank Round Collar		Hex Shank Round Collar		
Length	Part Number	Box Quantity	Part Number	Box Quantity	Part Number	Box Quantity	Part Number	Box Quantity	Weight lb
TOOTH									
12"	HH1-321-12	1	HH1-322-12	1	H3R-421-12	1	H3R-422-12	1	1.75

Ripper



Ripping and separating

	Round Shank Oval Collar		Hex Shank Oval Collar		Round Shank Round Collar		Hex Shank Round Collar		
Length	Part Number	Box Quantity	Part Number	Box Quantity	Part Number	Box Quantity	Part Number	Box Quantity	Weight lb
RIPPER									
12"	HH1-215R-12	5	HH1-214R-12	5	H3R-215R-12	5	H3R-214R-12	1	1.75

Round Nose



Pointed for piercing holes

	Round Shank Oval Collar		Hex Shank Oval Collar		Round Shank Round Collar		Hex Shank Round Collar		
Length	Part Number	Box Quantity	Part Number	Box Quantity	Part Number	Box Quantity	Part Number	Box Quantity	Weight lb
ROUND NOSE									
12"	HH1-215N-12	5	HH1-214N-12	5	H3R-215N-12	5	H3R-214N-12	1	1.5

Straight Fuller



Used on pipe and metal

	Round Shank Oval Collar		Hex Shank Oval Collar		Round Shank Round Collar		Hex Shank Round Collar		
Length	Part Number	Box Quantity	Part Number	Box Quantity	Part Number	Box Quantity	Part Number	Box Quantity	Weight lb
STRAIGHT FULLER									
12"	HH1-215J-12	1	HH1-214J-12	1	H3R-215J-12	1	H3R-214J-12	1	1.5

Gouge



Cupped end for gouging wood and concrete

	Round Shank Oval Collar		Hex Shank Oval Collar		Round Shank Round Collar		Hex Shank Round Collar		
Length	Part Number	Box Quantity	Part Number	Box Quantity	Part Number	Box Quantity	Part Number	Box Quantity	Weight lb
GOUGE									
12"	HH1-215G-12	5	HH1-214G-12	5	H3R-215G-12	5	H3R-214G-12	1	1.5

Caulking



Caulk removal

	Round Shank Oval Collar		Hex Shank Oval Collar		Round Shank Round Collar		Hex Shank Round Collar		
Length	Part Number	Box Quantity	Part Number	Box Quantity	Part Number	Box Quantity	Part Number	Box Quantity	Weight lb
CAULKING									
12"	HH1-215E-12	5	HH1-214E-12	5	H3R-215E-12	5	H3R-214E-12	1	1.75

Diamond Point



General demolition

	Round Shank Oval Collar		Hex Shank Oval Collar		Round Shank Round Collar		Hex Shank Round Collar		
Length	Part Number	Box Quantity	Part Number	Box Quantity	Part Number	Box Quantity	Part Number	Box Quantity	Weight lb
DIAMOND POINT									
12"	HH1-215D-12	1	HH1-214D-12	1	H3R-215D-12	1	H3R-214D-12	1	1.75

Cape Chisel



General demolition

	Round Shank Oval Collar		Hex Shank Oval Collar		Round Shank Round Collar		Hex Shank Round Collar		
Length	Part Number	Box Quantity	Part Number	Box Quantity	Part Number	Box Quantity	Part Number	Box Quantity	Weight lb
CAPE CHISEL									
12"	HH1-215C-12	5	HH1-214C-12	5	H3R-215C-12	5	H3R-214C-12	1	1.75

Paper Box Stripping Chisels

Paper Box Stripping Chisel

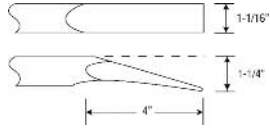

Length	Round Shank Round Collar Part Number	Dimensions	Weight lb	Box Quantity
PAPER BOX STRIPPING CHISEL				
22"	HHW1-S215-1	1-1/16" x 1-1/4" x 4"	4	5

Paper Box Stripping Chisel

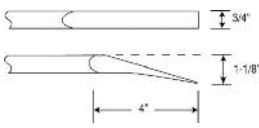

Length	Round Shank Round Collar Part Number	Dimensions	Weight lb	Box Quantity
PAPER BOX STRIPPING CHISEL				
16-1/4"	HHW1-S215-2	3/4" x 1-1/8" x 4"	2	5

Paper Box Stripping Chisel

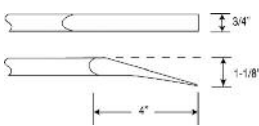

Length	Round Shank Round Collar Part Number	Dimensions	Weight lb	Box Quantity
PAPER BOX STRIPPING CHISEL				
22"	HHW1-S215-3	3/4" x 1-1/8" x 4"	2.5	5

Paper Box Stripping Chisel

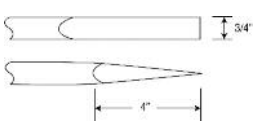

Length	Round Shank Round Collar Part Number	Dimensions	Weight lb	Box Quantity
PAPER BOX STRIPPING CHISEL				
22"	HHW1-S215-4	3/4" x 4"	2.5	5

Paper Box Stripping Chisel

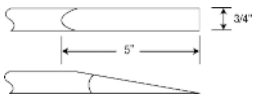

Length	Round Shank Round Collar Part Number	Dimensions	Weight lb	Box Quantity
PAPER BOX STRIPPING CHISEL				
16-1/4"	HHW1-S215-5	3/4" x 5"	2	5

Chipping Hammer Accessories

Upper Buffer Washer Lower Buffer Washer



Description	Part Number
BUFFER WASHERS	
Upper Buffer Washer (2 pieces)	H3R-31
Lower Buffer Washer (2 pieces)	HHW1-213

Lower Buffer Washer Ring



Description	Part Number
LOWER BUFFER WASHER RING	
Lower Buffer Washer Ring	R000A2-103

Rubber Bumper



Description	Part Number
RUBBER BUMPER	
Rubber Bumper	H3R-203

Lock Clip



Description	Part Number
LOCK CLIP	
Lock Clip	24SR-207

Chipping Hammer Retainers

Standard Retainer (grooved)



Barrel Area Type	K, A, D Series	Part Number	W Series
STANDARD RETAINER (STANDARD ON ALL CHIPPER ENDS IN "SA")			
Grooved		HH1-1190	N/A

Quick Change #1 (grooved)



Quick Change #2 (grooved)



Barrel Area Type	K, A, D Series	Part Number	W Series
QUICK CHANGE #1			
Grooved		HH1-1191	N/A
QUICK CHANGE #2			
Grooved		HH1-3400-3	N/A

Lock Spring (grooved)



Barrel Area Type	K, A, D Series	Part Number	W Series
LOCK SPRING (USED WITH ALL GROOVED RETAINERS LISTED ABOVE)			
Grooved		HH1-1194	N/A

Rubber Buffered (threaded)



Barrel Area Type	K, A, D Series	Part Number	W Series
RUBBER BUFFERED (STANDARD ON ALL W SERIES CHIPPER ENDS)			
Threaded		N/A	HHW1-A300

Economy Type (threaded)



Barrel Area Type	K, A, D Series	Part Number	W Series
ECONOMY TYPE			
Threaded		N/A	HHW2-200

Quick Change (threaded)



Barrel Area Type	K, A, D Series	Part Number	W Series
QUICK CHANGE			
Threaded		N/A	HHW1-3450



Pneumatic Hammer Chisels

Tested to meet the harshest of environments, Ingersoll Rand is proud to offer the following pneumatic hammer accessories. All chisels are built from high-quality steel for the utmost in quality, strength, and durability.

0.401 Shank Chisels

1/2" Flat Chisel



7"	Weight lb	9"	Weight lb	12"	Weight lb	18"	Weight lb	Box Quantity
1/2" FLAT CHISEL								
401FC127	0.5	401FC129	0.75	401FC1212	1	401FC1218	1.25	5

1/2" Offset Flat Chisel



7"	Weight lb	9"	Weight lb	12"	Weight lb	18"	Weight lb	Box Quantity
1/2" OFFSET FLAT CHISEL								
401OFC127	0.5	401OFC129	0.75	401OFC1212	1	401OFC1218	1.25	5

1/2" Sidecut Chisel



7"	Weight lb	9"	Weight lb	12"	Weight lb	18"	Weight lb	Box Quantity
1/2" SIDECUT CHISEL								
401SC127	0.75	401SC129	0.75	401SC1212	1	401SC1218	1.25	5

Offset Sidecut Chisel



7"	Weight lb	9"	Weight lb	12"	Weight lb	18"	Weight lb	Box Quantity
OFFSET SIDECUT CHISEL								
401OSC127	0.75							5

1-1/4" Wide Flat Blade



7"	Weight lb	9"	Weight lb	12"	Weight lb	18"	Weight lb	Box Quantity
1-1/4" WIDE FLAT BLADE								
401WBC1147	0.5	401WBC1149	0.75	401WBC11412	1	401WBC11418	1.25	5

0.401 Shank Chisels

Bull or Moil



7"	Weight lb	9"	Weight lb	12"	Weight lb	18"	Weight lb	Box Quantity
BULL OR MOIL								
401MP7	0.5	401MP9	0.75	401MP12	1	401MP18	1.25	5

3/4" Flat Chisel



7"	Weight lb	9"	Weight lb	12"	Weight lb	18"	Weight lb	Box Quantity
3/4" FLAT CHISEL								
401FC347	0.5	401FC349	0.75	401FC3412	1	401FC3418	1.5	5

Straight Blank



7"	Weight lb	9"	Weight lb	12"	Weight lb	18"	Weight lb	Box Quantity
STRAIGHT BLANK								
401B07	0.5	401B09	0.75	401B12	1	401B18	1.25	5

Accessories

9510



Manufacturer	Fits Models
9510	
Ingersoll Rand	115, 116, 117
Chicago Pneumatic	All 0.401 shank hammers except CP7 16
Cleco	E3, E4, E15, E16
Dayton	All models

- Quick-change hammer coupler
- Holds 0.401 shank chisels firmly in place; install by pulling back collar

9505



- 2 hammer-spring retainers
- Designed to guard against accidental shank release

Chisel Set

9500



- 5-piece high-quality chisel set made of heat-treated alloy
- Edging tool
 - Tailpipe cutter
 - Straight chisel
 - Cutting chisel
 - Tapered punch



Backfill Tamper and Sand Rammer Butts

Our line of tamper butts can meet all your compaction needs. These products complement the Ingersoll Rand line of backfill tamper and sand rammer tools, and can be used with other manufacturers' tools as well.

Steel Butts

Steel Butt



Part Number	Diameter	Fits Rods	Fits IR Tool
STEEL BUTT			
34SR-383	3"	7/8" tapered	341A2M

Steel Butt



Part Number	Diameter	Fits Rods	Fits IR Tool
STEEL BUTT			
12SR-83	2-1/2"	1/2" tapered	130A1M
22SR-83-3x3/4	3"	5/8" tapered	241A1M

Moon Steel Butt



Part Number	Diameter	Fits Rods	Fits IR Tool
MOON STEEL BUTT			
44SR-HM183-5	5-1/4"	1" tapered threaded	441A2

Malleable Butt



Part Number	Diameter	Fits Rods	Fits IR Tool
MALLEABLE BUTT			
44SR-M183-5-3/4	5-3/4"	1" tapered threaded	441A2
34SR-M183-5-3/4	5-3/4"	7/8" tapered	341A2M

Rubber Topping-off Butt



Part Number	Diameter	Fits Rods	Fits IR Tool
RUBBER TOPPING-OFF BUTT			
14SR-83R-4	3-29/32"	1/2" tapered	130A1M
24SR-83R-5	5"	5/8" tapered	241A1M

Rubber-tipped Butt



Part Number	Diameter	Fits Rods	Fits IR Tool
RUBBER-TIPPED BUTT			
14SR-83R-2-3/8	2-3/8"	1/2" tapered	130A1M
24SR-83R-3	3"	5/8" tapered	241A1M

Rubber-tipped Peen



Part Number	Diameter	Fits Rods	Fits IR Tool
RUBBER-TIPPED PEEN			
14SR-93R	2-3/8"	1/2" tapered	130A1M
24SR-93R	2-7/8"	5/8" tapered	241A1M



Scaler and Needle Scaler Steels

Ingersoll Rand chisel and needle scalers are your best solution for removing unwanted surface coatings and deposits. They're ideal for removing paint, rust, weld splatter and slag, and other materials.

Ingersoll Rand Scaler Chisels



Blank



Ingersoll Rand								
7"	Weight lb	Box Quantity	12"	Weight lb	Box Quantity	18"	Weight lb	Box Quantity
BLANK								
WF-14-007	0.5	5	WF-14-12	0.75	5	WF-14-18	1.25	5

Narrow



Ingersoll Rand								
7"	Weight lb	Box Quantity	12"	Weight lb	Box Quantity	18"	Weight lb	Box Quantity
NARROW								
WF-14F-7	0.5	5	WF-14F-12	0.75	5	WF-14F-18	1.25	5

Standard Wide



Ingersoll Rand								
7"	Weight lb	Box Quantity	12"	Weight lb	Box Quantity	18"	Weight lb	Box Quantity
STANDARD WIDE								
WF-14B-007	0.5	5	WF-14B-012	0.75	5	WF-14B-18	1.25	5

2" Wide

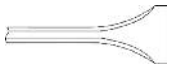

Ingersoll Rand								
7"	Weight lb	Box Quantity	12"	Weight lb	Box Quantity	18"	Weight lb	Box Quantity
2" WIDE								
WF-14C-007	0.5	5	WF-14C-012	0.75	5	WF-14C-018	1.5	5

Ingersoll Rand Scaler Chisels



3" Wide



Ingersoll Rand								
7"	Weight lb	Box Quantity	12"	Weight lb	Box Quantity	18"	Weight lb	Box Quantity
3" WIDE								
WF-14D-007	0.75	5	WF-14D-012	1	5	WF-14D-018	1.5	5

Spoon

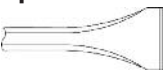

Ingersoll Rand								
7"	Weight lb	Box Quantity	12"	Weight lb	Box Quantity	18"	Weight lb	Box Quantity
SPOON								
WF-14A-007	0.5	5	WF-14A-12	0.75	5	WF-14A-18	1.25	5

Gouge



Ingersoll Rand								
7"	Weight lb	Box Quantity	12"	Weight lb	Box Quantity	18"	Weight lb	Box Quantity
GOUGE								
WF-14G-6	0.5	5						

2" Blade

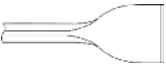

Ingersoll Rand								
7"	Weight lb	Box Quantity	12"	Weight lb	Box Quantity	18"	Weight lb	Box Quantity
2" BLADE								
89940613	0.5	1						

3" Blade

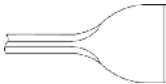

Ingersoll Rand								
7"	Weight lb	Box Quantity	12"	Weight lb	Box Quantity	18"	Weight lb	Box Quantity
3" BLADE								
22038749	0.75	1						

2" Blade (spark-resistant)

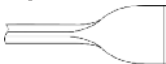

Ingersoll Rand								
7"	Weight lb	Box Quantity	12"	Weight lb	Box Quantity	18"	Weight lb	Box Quantity
2" BLADE (SPARK-RESISTANT)								
22038756	0.5	1						

CLECO Scaler Chisels



Blank



CLECO								
7"	Weight lb	Box Quantity	12"	Weight lb	Box Quantity	18"	Weight lb	Box Quantity
BLANK								
PF2200-391	0.5	5	PF2200-391-12	0.75	5	PF2200-391-18	1.25	5

Narrow



CLECO								
7"	Weight lb	Box Quantity	12"	Weight lb	Box Quantity	18"	Weight lb	Box Quantity
NARROW								
PF2200-392	0.5	5	PF2200-392-12	0.75	5	PF2200-392-18	1.25	5

Standard Wide

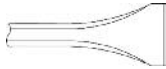

CLECO								
7"	Weight lb	Box Quantity	12"	Weight lb	Box Quantity	18"	Weight lb	Box Quantity
STANDARD WIDE								
PF2200-393	0.5	5	PF2200-393-12	0.75	5	PF2200-393-18	1.25	5

2" Wide

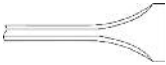

CLECO								
7"	Weight lb	Box Quantity	12"	Weight lb	Box Quantity	18"	Weight lb	Box Quantity
2" WIDE								
PF2200-390	0.5	5	PF2200-390-12	0.75	5	PF2200-390-18	1.5	5

3" Wide



CLECO								
7"	Weight lb	Box Quantity	12"	Weight lb	Box Quantity	18"	Weight lb	Box Quantity
3" WIDE								
PF2200-390-3	0.75	5	PF2200-390-3-12	1	5	PF2200-390-3-18	1.5	5

Spoon



CLECO								
7"	Weight lb	Box Quantity	12"	Weight lb	Box Quantity	18"	Weight lb	Box Quantity
SPOON								
PF2200-394	0.5	5	PF2200-394-12	0.75	5	PF2200-394-18	1.25	5

Round Nose



CLECO								
7"	Weight lb	Box Quantity	12"	Weight lb	Box Quantity	18"	Weight lb	Box Quantity
ROUND NOSE								
PF2200-3231	0.5	5						

Cape



CLECO								
7"	Weight lb	Box Quantity	12"	Weight lb	Box Quantity	18"	Weight lb	Box Quantity
CAPE								
PF2200-3232	0.5	5						

CP Scaler Chisels

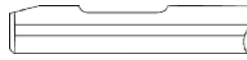

Blank



CP								
7"	Weight lb	Box Quantity	12"	Weight lb	Box Quantity	18"	Weight lb	Box Quantity
BLANK								
CP2100-07	0.5	5	CP2100-12	0.75	5	CP2100-18	1.25	5

Narrow



CP								
7"	Weight lb	Box Quantity	12"	Weight lb	Box Quantity	18"	Weight lb	Box Quantity
NARROW								
CP2153-07	0.5	5	CP2153-12	0.75	5	CP2153-18	1.25	5

Standard Wide



CP								
7"	Weight lb	Box Quantity	12"	Weight lb	Box Quantity	18"	Weight lb	Box Quantity
STANDARD WIDE								
CP2151-07	0.5	5	CP2151-12	0.75	5	CP2151-18	1.25	5

2" Wide

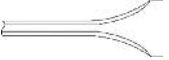

CP								
7"	Weight lb	Box Quantity	12"	Weight lb	Box Quantity	18"	Weight lb	Box Quantity
2" WIDE								
CP2107-07	0.5	5	CP2107-12	0.75	5	CP2107-18	1.5	5

3" Wide

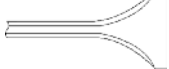

CP								
7"	Weight lb	Box Quantity	12"	Weight lb	Box Quantity	18"	Weight lb	Box Quantity
3" WIDE								
CP2142-07	0.75	5	CP2142-12	1	5			

Spoon



CP								
7"	Weight lb	Box Quantity	12"	Weight lb	Box Quantity	18"	Weight lb	Box Quantity
SPOON								
CP2154-07	0.5	5	CP2154-12	0.75	5	CP2154-18	1.25	5

Needle Scaler Housings

Round Needle Housing



Part Number	Description
ROUND NEEDLE HOUSING	
NS11A	With 5" (127 mm) steel needles
NS11AS	With 5" (127 mm) stainless steel needles
NS11A7	With 7" (178 mm) extended steel needles — optional

Rectangular Needle Housing



Part Number	Description
RECTANGULAR NEEDLE HOUSING	
NS11BB	With 5" (127 mm) beryllium copper needles
NS11BS	With 5" (127 mm) stainless steel needles
NS11B7	With 7" (178 mm) extended steel needles

Replacement Needle

Part Number	Description
REPLACEMENT NEEDLE — SET OF 19 NEEDLES (3 mm)	
NS11-22-19	5" (127 mm) steel needles — standard
NS11-B22-19	5" (127 mm) beryllium copper needles — optional
NS11-S22-19	5" (127 mm) stainless steel needles — optional
NS11-122-19	7" (178 mm) extended steel needles — optional

Bulk Needles

Part Number	Description	Quantity
BULK NEEDLE		
22038194	2 mm needle holder for 170PG	N/A
22038202	2 mm needle holder for 180PG	N/A
22038210	4 mm needle holder for 180PG	N/A
22038525	2 mm flat tip 7" steel	100
22038533	3 mm flat tip 5" steel	100
22038566	3 mm flat tip 7" beryllium	500
22038558	3 mm flat tip 7" beryllium	100
22038541	3 mm flat tip 7" steel	1,000
89940597	3 mm flat tip 7" steel	100
22038582	3 mm chisel tip 7" steel	1,000
22038574	3 mm chisel tip 7" steel	100
22038608	3 mm pointed tip 7" steel	1,000
22038590	3 mm pointed tip 7" steel	100
22038624	4 mm flat tip 7" steel	500
22038616	4 mm flat tip 7" steel	100
22038640	4 mm chisel tip 7" steel	500
22038632	4 mm chisel tip 7" steel	100
22038665	4 mm pointed tip 7" steel	500
22038657	4 mm pointed tip 7" steel	100

Cross-reference Tables

Ajax	Ingersoll Rand	Ajax	Ingersoll Rand	Ajax	Ingersoll Rand	Ajax	Ingersoll Rand	Ajax	Ingersoll Rand	Ajax	Ingersoll Rand
10010	BT41310	282	9001-282	32100	50197912	384-12	WF-14A-18	411	H3R-215M-12	47300	50191790
11060	FW40810	283	9001-283	32200	50055524	384-18	WF-14A-12	411-18	H3R-215M-18	48400	50185990
11080	22040968	28400	50190404	323	HH1-323-9	38400	50185982	411-24	H3R-215M-24	49500	50189570
11100	50199207	295	9001-295-9-1/2	323-12	HH1-323-12	390	PF2200-390	411-36	H3R-215M-36	50100	HH1-215T-9
11200	50050269	29500	50189554	323-12-3	HH1-215S-12	390-3	PF2200-390-3	41100	50196385	50200	HH1-214T-9
11300	50195288	296	9001-297-9	323-18	HH1-323-18	391	PF2200-391	412	H3R-214M-12	50300	H3R-215T-9
12100	50199215	297	9001-297-12	323-24	HH1-323-24	391-12	PF2200-391-12	412-18	H3R-214M-18	50400	H3R-214T-9
12200	50050277	297-18	9001-297-18	323-48	HH1-323-48	391-18	PF2200-391-18	412-24	H3R-214M-24	5521	22038574
12300	50195296	297-24	9001-297-24	323-60	HH1-323-60	392	PF2200-392	412-36	H3R-214M-36	5521	22038582
13100	50199223	300	HH1-1194	323-72	HH1-323-72	392-12	PF2200-392-12	41200	50055680	5522	22038616
13200	50050285	30010	BT41330	3231	PF2200-3231	392-18	PF2200-392-18	413-12	H3R-215C-12	5522	22038624
13300	45510542	301-12	HH1-215-12	3232	PF2200-3232	393	PF2200-393	41300	50193879	5523	22038632
1379	NS11-122-19	301-18	HH1-215-18	32300	50193754	393-12	PF2200-393-12	414-12	H3R-214C-12	5523	22038640
14100	45510682	301-24	HH1-215-24	324-12-3	HH1-214S-12	393-18	PF2200-393-18	417-12	H3R-215N-12	5525	22038558
14200	51305860	301-36	HH1-215-36	324	HH1-324-9	394	PF2200-394	41700	CB40970	5525	22038566
14300	45510559	302-12	HH1-214-12	324-12	HH1-324-12	394-12	PF2200-394-12	41701	22040604	60010	WB5869
1472	H3R-31	302-18	HH1-214-18	324-18	HH1-324-18	394-18	PF2200-394-18	418-12	H3R-214N-12	60020	WB58912
1473	H3R-203	302-24	HH1-214-24	324-24	HH1-324-24	395	CP2100-07	419-12	H3R-215D-12	60030	WB581518
1474	HHW1-213	302-36	HH1-214-36	324-36	HH1-324-36	395-12	CP2100-12	420-12	H3R-214D-12	60040	WB3469
18400	22040935	303	HH1-215F-9	324-48	HH1-324-48	395-18	CP2100-18	42100	50196401	60050	WB34912
19500	50189596	303-12	HH1-215F-12	324-60	HH1-324-60	39500	50189562	42200	50055698	60060	WB341518
20010	BT41320	303-18	HH1-215F-18	324-72	HH1-324-72	396	CP2153-07	423	H3R-423-9	60070	WB342124
206	89938450	303-24	HH1-215F-24	325	HH1-215B-9	396-12	CP2153-12	423-12	H3R-423-12	60080	WB342730
21060	FW40820	303-36	HH1-215F-36	325-12	HH1-215B-12	396-18	CP2153-18	423-12-3	H3R-215S-12	60090	WB7869
21080	22040976	303-48	HH1-215F-48	325-18	HH1-215B-18	397	CP2151-07	423-18	H3R-423-18	60100	WB78912
21100	50197805	303-60	HH1-215F-60	326	HH1-214B-9	397-12	CP2151-12	423-24	H3R-423-24	60110	WB781518
21200	50050368	303-72	HH1-215F-72	326-12	HH1-214B-12	397-18	CP2151-18	423-36	H3R-423-36	60120	WB782124
21300	50195320	304	HH1-214F-9	326-18	HH1-214B-18	398	CP2154-07	423-48	H3R-423-48	60130	WB782730
21701	22040588	304-12	HH1-214F-12	33100	50197938	398-12	CP2154-12	423-60	H3R-423-60	60150	WB1912
22100	50197821	304-18	HH1-214F-18	33200	50055540	398-18	CP2154-18	423-72	H3R-423-72	60160	WB11518
22200	50050376	304-24	HH1-214F-24	33300	50193747	399	CP2107-07	42300	50193887	60170	WB12124
22300	50195338	304-36	HH1-214F-36	337-12	HH1-215G-12	399-3	CP2142-07	424	H3R-424-9	60180	WB12730
23100	45510245	304-48	HH1-214F-48	338-12	HH1-214G-12	40010	BT41340	424-12	H3R-424-12	60190	WB118912
23200	50050392	304-60	HH1-214F-60	3400	HH1-3400-3	403	H3R-215-12	424-18	H3R-424-18	60200	WB1181518
23300	50195353	304-72	HH1-214F-72	34100	51298107	403-18	H3R-215-18	424-24	H3R-424-24	60210	WB1182124
24100	45510252	305-12	HH1-215C-12	34200	50055565	403-24	H3R-215-24	424-36	H3R-424-36	60220	WB1182730
24200	45512563	306-12	HH1-214C-12	34300	45510500	403-36	H3R-215-36	424-48	H3R-424-48	60230	WB114912
24300	50195361	307-12	HH1-215N-12	3450	HHW1-3450	404	H3R-214-12	424-60	H3R-424-60	60240	WB1141518
25100	45510260	308-12	HH1-214N-12	35100	50197979	404-18	H3R-214-18	424-72	H3R-424-72	60250	WB1142124
25200	45512571	309-12	HH1-215D-12	35200	50055573	404-24	H3R-214-24	425	H3R-215B-9	60260	WB1142730
25300	50195379	310-12	HH1-214D-12	35300	45510518	404-36	H3R-214-36	425-12	H3R-215B-12	60270	WB138912
26100	45510278	31060	FW40830	36100	50197987	405	H3R-215F-9	425-18	H3R-215B-18	60280	WB1381518
26200	45512589	31080	22040984	36200	50055581	406	H3R-214F-9	426	H3R-214B-9	60290	WB1382124
26300	45510476	311-12	HH1-215R-12	36300	45510526	407	H3R-215F-12	426-12	H3R-214B-12	60300	WB1382730
27100	45510286	31100	50197904	37100	50197995	407-18	H3R-215F-18	426-18	H3R-214B-18	60310	WB112912
272	9001-220	312-12	HH1-214R-12	37200	50055599	407-24	H3R-215F-24	43100	50196419	60320	WB1121518
27200	45512597	31200	50050475	37300	45510534	407-36	H3R-215F-36	43200	50055714	60330	WB1122124
27300	51304574	313	HH1-215M-9	3750	HHW1-A300	407-48	H3R-215F-48	43300	50193903	60340	WB1122730
274	9001-201	31300	50114883	379	22038541	407-60	H3R-215F-60	437-12	H3R-215G-12	60350	WBA5869
275	9001-203	314	HH1-214M-9	380	WF-14C-007	407-72	H3R-215F-72	438-12	H3R-214G-12	60360	WBA58912
276	9001-276-9-1/2	315	HH1-215M-12	380-3	WF-14D-007	408	H3R-214F-12	44100	51299477	60370	WBA581518
276-12	9001-276-12	315-18	HH1-215M-18	381	WF-14-007	408-18	H3R-214F-18	44200	50055730	60380	WBA3469
276-18	9001-276-18	315-24	HH1-215M-24	381-12	WF-14-12	408-24	H3R-214F-24	44300	45510484	60390	WBA34912
276-24	9001-276-24	315-36	HH1-215M-36	381-18	WF-14-18	408-36	H3R-214F-36	45100	51299485	60390	WBA582124
277	9001-277-9-1/2	316	HH1-214M-12	382	WF-14F-7	408-48	H3R-214F-48	45200	50055748	60400	WBA341518
277-12	9001-277-12	316-18	HH1-214M-18	382-12	WF-14F-12	408-60	H3R-214F-60	45300	50193937	60410	WBA342124
277-18	9001-277-18	316-24	HH1-214M-24	382-18	WF-14F-18	408-72	H3R-214F-72	46100	51299048	60420	WBA342730
278	9001-278	316-36	HH1-214M-36	383	WF-14B-007	409	H3R-215M-9	46200	50055755	60430	WBA7869
279	9001-279	31700	CB40960	383-12	WF-14B-012	410	H3R-214M-9	46300	45510492	60440	WBA78912
280	9001-280	31701	22040596	383-18	WF-14B-18	41060	FW40840	47100	51299493	60450	WBA781518
281	9001-281	321-12	HH1-321-12	384	WF-14A-007	41080	50186014	47200	50198993	60460	WBA782124

Don't see what you're looking for?

Call (866) IR4-TOOL

Pioneer	Ingersoll Rand	Pioneer	Ingersoll Rand	Pioneer	Ingersoll Rand	Pioneer	Ingersoll Rand	Tamco	Ingersoll Rand	Tamco	Ingersoll Rand
189216	22040588	35409	HH1-324-9	41207	PF2200-392	8015	51248391	1436-012	HH1-321-12	1607-036	H3R-423-36
19114	50050475	35409R	H3R-424-9	41212	PF2200-392-12	8015CM	51248334	1442-012	HH1-215S-12	1607-048	H3R-423-48
19118	50055524	35412	HH1-324-12	41218	PF2200-392-18	8016	51248409	1445-012	HH1-215J-12	1607-060	H3R-423-60
19124	50055540	35412R	H3R-424-12	41307	PF2200-393	8016CM	51248342	1482-009	HH1-215T-9	1607-072	H3R-423-72
19136	50055565	35418	HH1-324-18	41312	PF2200-393-12	8017CM	51356723	1500-011	HH1-214-12	1607-084	H3R-423-84
19148	50055573	35418R	H3R-424-18	41318	PF2200-393-18	8018CM	51293017	1500-017	HH1-214-18	1607-096	H3R-423-96
19160	50055581	35512	HH1-214S-12	41407	PF2200-390	81012	50713023	1500-023	HH1-214-24	1611-009	H3R-215M-9
19172	50055599	35512R	H3R-214S-12	41412	PF2200-390-12	81018	50713031	1500-035	HH1-214-36	1611-012	H3R-215M-12
19196	45512522	3570	HH1-214T-9	41418	PF2200-390-18	81024	50354596	1501-009	HH1-214F-9	1611-018	H3R-215M-18
19214	50197904	3570R	H3R-214T-9	41507	PF2200-390-3	81030	51305704	1501-012	HH1-214F-12	1611-024	H3R-215M-24
19218	50197912	36109	HH1-215M-9	41512	PF2200-390-3-12	81036	50713049	1501-018	HH1-214F-18	1611-036	H3R-215M-36
19224	50197938	36109R	H3R-215M-9	41518	PF2200-390-3-18	81060	50713056	1501-024	HH1-214F-24	1612-012	H3R-215D-12
19236	51298107	36112	HH1-215M-12	41707	PF2200-394	81072	50283696	1501-036	HH1-214F-36	1613-012	H3R-215C-12
19248	50197979	36112R	H3R-215M-12	41712	PF2200-394-12	81096	50283241	1501-048	HH1-214F-48	1617-012	H3R-215N-12
19260	50197987	36118	HH1-215M-18	41718	PF2200-394-18	810120	50712132	1501-060	HH1-214F-60	1623-012	H3R-215S-12
19272	50197995	36118R	H3R-215M-18	42007	WF-14-007	87312	45509585	1501-072	HH1-214F-72	1625-012	H3R-215R-12
19296	45510393	36124	HH1-215M-24	42012	WF-14-12	87318	50283266	1501-084	HH1-214F-84	1627-012	H3R-215E-12
19314	50114883	36124R	H3R-215M-24	42018	WF-14-18	87324	50283506	1501-096	HH1-214F-96	1636-012	H3R-421-12
19318	50193754	36136	HH1-215M-36	42207	WF-14F-7	87330	51305639	1506-009	HH1-214B-9	1642-012	H3R-215S-12
19324	50193747	36136R	H3R-215M-36	42212	WF-14F-12	87336	50712728	1506-012	HH1-214B-12	1645-012	H3R-215J-12
19336	45510500	36209	HH1-215F-9	42218	WF-14F-18	87348	50283555	1506-018	HH1-214B-18	1682-009	H3R-215T-9
19348	45510518	36209R	H3R-215F-9	42307	WF-14B-007	87372	50712744	1507-009	HH1-324-9	1700-011	H3R-214-12
19360	45510526	36212	HH1-215F-12	42312	WF-14B-012	87396	50712751	1507-012	HH1-324-12	1700-017	H3R-214-18
19372	45510534	36212R	H3R-214F-12	42318	WF-14B-18	873120	45509593	1507-018	HH1-324-18	1700-023	H3R-214-24
1944	FW40830	36218	HH1-215F-18	42407	WF-14C-007	87412	51242006	1507-024	HH1-324-24	1700-035	H3R-214-36
1950	50185982	36218R	H3R-215F-18	42412	WF-14C-012	87418	51242014	1507-036	HH1-324-36	1701-009	H3R-214F-9
1955	50189562	36224	HH1-215F-24	42418	WF-14C-018	87424	51233690	1507-048	HH1-324-48	1701-012	H3R-215F-12
1956	CB40960	36224R	H3R-215F-24	42507	WF-14D-007	87430	51242030	1507-060	HH1-324-60	1701-018	H3R-214F-18
1978	22040984	36236	HH1-215F-36	42512	WF-14D-012	87436	51234052	1507-072	HH1-324-72	1701-024	H3R-214F-24
19709	BT41330	36236R	H3R-215F-36	42518	WF-14D-018	87448	51234060	1507-084	HH1-324-84	1701-036	H3R-214F-36
19915	50187848	36248	HH1-215F-48	42707	WF-14A-007	87472	50712975	1507-096	HH1-324-96	1701-048	H3R-214F-48
199216	22040596	36248R	H3R-215F-48	42712	WF-14A-18					1701-060	H3R-214F-60
32109	9001-297-9	36260	HH1-215F-60	42718	WF-14A-12					1701-072	H3R-214F-72
32112	9001-297-12	36260R	H3R-215F-60	44007	CP2100-07					1701-084	H3R-214F-84
32118	9001-297-18	36272	HH1-215F-72	44012	CP2100-12					1701-096	H3R-214F-96
35109	HH1-214M-9	36272R	H3R-215F-72	44018	CP2100-18					1707-009	H3R-424-9
35109R	H3R-214M-9	36309	HH1-215B-9	44207	CP2153-07					1707-012	H3R-424-12
35112	HH1-214M-12	36309R	H3R-215B-9	44212	CP2153-12					1707-018	H3R-424-18
35112R	H3R-214M-12	36312	HH1-215B-12	44218	CP2153-18					1707-024	H3R-424-24
35118	HH1-214M-18	36312R	H3R-215B-12	44307	CP2151-07					1707-036	H3R-424-36
35118R	H3R-214M-18	36318	HH1-215B-18	44312	CP2151-12					1707-048	H3R-424-48
35124	HH1-214M-24	36318R	H3R-215B-18	44318	CP2151-18					1707-060	H3R-424-60
35124R	H3R-214M-24	36409	HH1-323-9	44407	CP2107-07					1707-072	H3R-424-72
35136	HH1-214M-36	36409R	H3R-423-9	44412	CP2107-12					1707-084	H3R-424-84
35136R	H3R-214M-36	36412	HH1-323-12	44507	CP2142-07					1707-096	H3R-424-96
35209	HH1-214F-9	36412R	H3R-423-12	44512	CP2142-12					1711-009	H3R-214M-9
35209R	H3R-214F-9	36418	HH1-323-18	44707	CP2154-07					1600-011	H3R-215-12
35212	HH1-214F-12	36418R	H3R-423-18	44712	CP2154-12					1600-017	H3R-215-18
35212R	H3R-215F-12	36512	HH1-215S-12	44718	CP2154-18					1600-023	H3R-215-24
35218	HH1-214F-18	36512R	H3R-215S-12	52212	9001-276-12					1600-035	H3R-215-36
35218R	H3R-214F-18	3670	HH1-215T-9	52218	9001-276-18					1601-009	H3R-215F-9
35224	HH1-214F-24	3670R	H3R-215T-9	52309	9001-277-9-1/2					1601-012	H3R-214F-12
35224R	H3R-214F-24	390107	401MP7	52312	9001-277-12					1601-018	H3R-215F-18
35236	HH1-214F-36	390112	401MP12	52318	9001-277-18					1601-024	H3R-215F-24
35236R	H3R-214F-36	390118	401MP18	52706	9001-278					1601-036	H3R-215F-36
35248	HH1-214F-48	390207	401FC127	52708	9001-279					1601-048	H3R-215F-48
35248R	H3R-214F-48	390212	401FC1212	52710	9001-280					1601-060	H3R-215F-60
35260	HH1-214F-60	390218	401FC1218	52712	9001-281					1601-072	H3R-215F-72
35260R	H3R-214F-60	390307	401WBC1147	52714	9001-282					1601-084	H3R-215F-84
35272	HH1-214F-72	390312	401WBC11412	52716	9001-283					1601-096	H3R-215F-96
35272R	H3R-214F-72	390318	401WBC11418	52810	9001-295-9-1/2					1606-009	H3R-215B-9
35309	HH1-214B-9	392207	401FC347	8011	51248359					1606-012	H3R-215B-12
35309R	H3R-214B-9	392212	401FC3412	8011CM	51307155					1606-018	H3R-215B-18
35312	HH1-214B-12	392218	401FC3418	8012	51248367					1607-009	H3R-423-9
35312R	H3R-214B-12	41007	PF2200-391	8013	51248375					1607-012	H3R-423-12
35318	HH1-214B-18	41012	PF2200-391-12	8014	51248383					1607-018	H3R-423-18
35318R	H3R-214B-18	41018	PF2200-391-18	8014CM	51248326					1607-024	H3R-423-24

Tamco	Ingersoll Rand	Vulcan	Ingersoll Rand	Vulcan	Ingersoll Rand	Vulcan	Ingersoll Rand	Vulcan	Ingersoll Rand	Vulcan	Ingersoll Rand
44-030441	WB1581518	520-2	50283506	551-12	WB78912	557-24SP	WBA11582124	F0271	HH1-215G-12	G02842	HH1-324-36
44-030442	WBA1581518	520-2.5	51305639	551-12SPL	WBC78912	55-30SPL	WBC1382730	F02802	HH1-323-9	G02852	HH1-324-48
44-03045	WB1122730	520-3	50712728	551-18	WB781518	6000	9001-220	F02805	HH1-215B-9	G02862	HH1-324-60
44-03046	WB1124548	520-4	50283555	551-18SPL	WBC781518	7000	9001-201	F02812	HH1-323-12	G02872	HH1-324-72
44-030474	WB11582124	520-5	50712736	551-24	WB782124	8000	9001-203	F02815	HH1-215B-12	G101	H3R-214-12
44-ORB22H	51248359	520-6	50712744	551-24SPL	WBC782124	810	FW40820	F02822	HH1-323-18	G102	H3R-214-18
44-ORB24H	51248367	5200	9001-277-9-1/2	551-30	WB782730	8100	89938450	F02825	HH1-215B-18	G103	H3R-214-24
44-ORB26H	51248375	5201	9001-277-12	551-30SPL	WBC782730	8100C	HH1-1194	F02832	HH1-323-24	G104	H3R-214-36
44-ORB28H	51248383	5202	9001-277-18	551-36	WB783336	812	FW40830	F02852	HH1-323-48	G120	H3R-214M-9
44-ORB30H	51248391	521-1	51242006	552-12	WB1912	813	FW40840	F02862	HH1-323-60	G121	H3R-214M-12
44-ORB32H	51248409	521-1.5	51242014	552-12SPL	WBC18912	846	BT41310	F02872	HH1-323-72	G122	H3R-214M-18
HTI-137H	51307155	521-2	51233690	552-18	WB11518	847	BT41320	F101	H3R-215-12	G123	H3R-214M-24
HTI-175H	51248326	521-2.5	51242030	552-18SPL	WBC11518	848	BT41330	F102	H3R-215-18	G124	H3R-214M-36
HTI-150H	51248300	521-3	51234052	552-24	WB12124	849	BT41340	F103	H3R-215-24	G180	H3R-214F-9
HTI-162H	51248318	521-4	51234060	552-24SPL	WBC12124	9136	22040463	F104	H3R-215-36	G181	H3R-214F-12
HTI-187H	51248334	521-6	50712975	552-30	WB12730	9156	22040471	F120	H3R-215M-9	G182	H3R-214F-18
HTI-200H	51248342	522-1	50713023	552-30SPL	WBC12730	9166	22040489	F121	H3R-215M-12	G183	H3R-214F-24
HTI-225H	51356723	522-1.5	50713031	552-36	WB13336	923	50199207	F122	H3R-215M-18	G184	H3R-214F-36
HTI-250H	51293017	522-2	50354596	553-12	WB118912	924	50199215	F123	H3R-215M-24	G185	H3R-214F-48
		522-2.5	51305704	553-12SP	WBA118912	924-2	50199223	F124	H3R-215M-36	G186	H3R-214F-60
Vulcan	Ingersoll Rand	522-3	50713049	553-12SPL	WBC118912	925	50197805	F180	H3R-215F-9	G187	H3R-214F-72
1011	50050269	522-4	50283183	553-18	WB1181518	926	50197821	F181	H3R-214F-12	G2802	H3R-424-9
1012	50050277	522-5	50713056	553-18SP	WBA1181518	926-2	45510245	F182	H3R-215F-18	G2805	H3R-214B-9
1012-2	50050285	522-6	50283696	553-18SPL	WBC1181518	934	50195288	F183	H3R-215F-24	G2812	H3R-424-12
1012-3	51305860	522-8	50283241	553-24	WB1182124	935	50195296	F184	H3R-215F-36	G2815	H3R-214B-12
1013	50050368	5300	9001-295-9-1/2	553-24SP	WBA1182124	935-2	45510542	F185	H3R-215F-48	G2822	H3R-424-18
1014	50050376	5400	9001-278	553-24SPL	WBC1182124	936	50195320	F186	H3R-215F-60	G2825	H3R-214B-18
1014-2	50050392	5401	9001-279	553-30	WB1182730	937	50195338	F187	H3R-215F-72	G2832	H3R-424-24
1019	50050475	5402	9001-280	553-30SP	WBA1182730	937-2	50195353	F2802	H3R-423-9	G2842	H3R-424-36
1020	50055524	5403	9001-281	553-30SPL	WBC1182730	942	22040935	F2805	H3R-215B-9	G2852	H3R-424-48
1020-2	50055540	5404	9001-282	553-36	WB1183336	943	50190404	F2812	H3R-423-12	G2862	H3R-424-60
1020-3	50055565	5405	9001-283	554-12	WB114912	945	22040968	F2815	H3R-215B-12	G2872	H3R-424-72
1023	50055680	546	WB5869	554-12SP	WBA114912	946	22040976	F2822	H3R-423-18	HC112	51248300
1024	50055698	546SP	WBA5869	554-12SPL	WBC114912	972	50189554	F2825	H3R-215B-18	HC134	51248326
1024-2	50055714	546-12	WB58912	554-18	WB1141518	982	50189596	F2832	H3R-423-24	HC138	51307155
1024-3	50055730	546-12SP	WBA58912	554-18SP	WBA1141518	CR100	PF2200-391	F2842	H3R-423-36	HC158	51248318
1030	50197904	546-18	WB581518	554-18SPL	WBC1141518	CR101	PF2200-391-12	F2852	H3R-423-48	HC178	51248334
1031	50197912	546-18SP	WBA581518	554-24	WB1142124	CR102	PF2200-391-18	F2862	H3R-423-60	HC200	51248342
1031-2	50197938	546-24	WB582124	554-24SP	WBA1142124	CR180	PF2200-392	F2872	H3R-423-72	HC212	51293017
1031-3	51298107	547	WBA3469	554-24SPL	WBC1142124	CR181	PF2200-392-12	G0101	HH1-214-12	HC214	51356723
1034	50196385	547-12	WBA582124	554-30	WB1142730	CR182	PF2200-392-18	G0102	HH1-214-18	HSC112	51248367
1035	50196401	547-18	WBA341518	554-30SP	WBA1142730	CR2805	PF2200-393	G0103	HH1-214-24	HSC134	51248383
1035-2	50196419	547-24	WBA342124	554-30SPL	WBC1142730	CR2805A	PF2200-394	G0104	HH1-214-36	HSC138	51248359
1035-3	51299477	547-30	WBA342730	554-36	WB1143336	CR2815	PF2200-393-12	G0120	HH1-214M-9	HSC158	51248375
1040	50114883	547-36	WBA343336	555-12	WB138912	CR2815A	PF2200-394-12	G0121	HH1-214M-12	HSC178	51248391
1041	50193754	548	WBA7869	555-12SP	WBA138912	CR2825	PF2200-393-18	G0122	HH1-214M-18	HSC200	51248409
1041-2	50193747	548-12	WBA78912	555-12SPL	WBC138912	CR2825A	PF2200-394-18	G0123	HH1-214M-24	MS100	CP2100-07
1042	50193879	548-18	WBA781518	555-18	WB1381518	F0101	HH1-215-12	G0124	HH1-214M-36	WF100	WF-14-007
1043	50193887	548-24	WBA782124	555-18SP	WBA1381518	F0102	HH1-215-18	G0161	HH1-214C-12	WF101	WF-14-12
1043-2	50193903	548-30	WBA782730	555-18SPL	WBC1381518	F0103	HH1-215-24	G0180	HH1-214F-9	WF102	WF-14-18
1045	50185982	548-36	WBA783336	555-24SP	WBA1382124	F0104	HH1-215-36	G0181	HH1-214F-12	WF180	WF-14F-7
1046	50185990	549-12	WBA1912	555-24SPL	WBC1382124	F0120	HH1-215M-9	G0182	HH1-214F-18	WF181	WF-14F-12
1048	22040984	549-18	WBA11518	555-30	WB1382730	F0121	HH1-215M-12	G0183	HH1-214F-24	WF182	WF-14F-18
1049	50186014	549-24	WBA12124	555-30SP	WBA1382730	F0122	HH1-215M-18	G0184	HH1-214F-36	WF2805	WF-14B-007
1075	50189562	549-30	WBA12730	556-12	WB112912	F0123	HH1-215M-24	G0185	HH1-214F-48	WF2805A	WF-14A-007
1077	50189570	549-36	WBA13336	556-12SP	WBA112912	F0124	HH1-215M-36	G0186	HH1-214F-60	WF2815	WF-14B-012
1803	22040588	550	WB3469	556-12SPL	WBC112912	F0161	HH1-215C-12	G0187	HH1-214F-72	WF2815A	WF-14A-18
1806	22040596	550-12	WB34912	556-18	WB1121518	F0180	HH1-215F-9	G0201	HH1-214D-12	WF2825	WF-14B-18
1808	22040604	550-12SPL	WBC34912	556-18SP	WBA1121518	F0181	HH1-215F-12	G0261	HH1-214N-12	WF2825A	WF-14A-12
5000	9001-297-9	550-18	WB341518	556-18SPL	WBC1121518	F0182	HH1-215F-18	G0271	HH1-214G-12		
5001	9001-297-12	550-18SPL	WBC341518	556-24	WB1122124	F0183	HH1-215F-24	G02802	HH1-324-9		
5002	9001-297-18	550-24	WB342124	556-24SP	WBA1122124	F0184	HH1-215F-36	G02805	HH1-214B-9		
5100	9001-276-9-1/2	550-24SPL	WBC342124	556-24SPL	WBC1122124	F0185	HH1-215F-48	G02812	HH1-324-12		
5101	9001-276-12	550-30	WB342730	556-30	WB1122730	F0186	HH1-215F-60	G02815	HH1-214B-12		
5102	9001-276-18	550-30SPL	WBC342730	556-30SP	WBA1122730	F0187	HH1-215F-72	G02822	HH1-324-18		
520-1	45509585	550-36	WB343336	556-30SPL	WBC1122730	F0201	HH1-215D-12	G02825	HH1-214B-18		
520-1.5	50283266	551	WB7869	557-24	WB11582124	F0261	HH1-215N-12	G02832	HH1-324-24		

Safety

ENGLISH

Product Description

The term "accessory" refers to each tool mentioned in this catalog.

WARNING

Failure to observe the following warnings could result in injury. Make this safety information available to users.

- Read and understand all warnings and manuals supplied with the tool and accessory.
- Always turn off the air supply, bleed the air pressure, and disconnect the air supply hose before installing, removing, or adjusting this accessory.
- Inspect the accessory for signs of irregularities such as cracks, fractures, excessive wear, or corrosion. Do not use if signs of irregularities are found.
- Always use personal protective equipment appropriate to the accessory used and the material worked. This may include dust mask or other breathing apparatus, safety glasses, ear plugs, gloves, apron, safety shoes, hard hat, and other equipment.
- Accessory is not designed for working in explosive environments or around electrical hazards.
- Do not touch this accessory with your hands or any other part of your body while in use.
- Never use these accessories as hand chisels or strike them with a hand-driven hammer.
- Do not use the accessory for prying.
- Always ensure the temperature of accessory is above 32° F (0° C) before use. Warm accessory when necessary.
- A tool steel may break in use. Keep clear and maintain a balanced and firm stance.
- Do not touch the accessory or percussive tool parts near accessory during or immediately after operation. A burn may result.

Ingersoll Rand tool safety manuals can be downloaded from irtools.com.

Refer all communications to the nearest Ingersoll Rand office or distributor.

FRENCH

Description du produit

Cet acier d'outillage a été conçu pour être utilisé avec des outils à percussion pneumatiques. Le terme « accessoire » est employé ci-après en référence à cet acier d'outillage.

AVERTISSEMENT

Le non respect des avertissements ci-dessous peut entraîner des blessures. Veillez à mettre ces informations de sécurité à disposition des utilisateurs.

- Veillez à bien lire et comprendre tous les avertissements et tous les manuels fournis avec l'outil et ses accessoires.
- Veillez à toujours couper l'alimentation en air, à purger la pression, et à débrancher le tuyau d'alimentation avant d'installer, de retirer ou de régler cet accessoire.
- Inspectez l'accessoire en vue de détecter les éventuels signes d'irrégularités, tels que des fissures, des cassures, une usure excessive ou de la corrosion. N'utilisez pas l'outil en présence d'une de ces anomalies.
- Portez toujours des équipements de protection individuelle appropriés à l'accessoire utilisé et au matériau usiné. Il peut s'agir de masques anti-poussière ou d'autres dispositifs respiratoires, de lunettes de sécurité, de bouchons anti-bruit, de gants, d'un tablier, de chaussures de sécurité, d'un casque, etc.
- Les accessoires ne sont pas conçus pour fonctionner dans des environnements explosifs ou à proximité de dangers électriques.
- Ne touchez pas l'accessoire avec vos mains ou toute autre partie du corps lorsqu'il est en marche.
- N'utilisez jamais ces accessoires comme burins manuels et ne les tapez jamais avec un marteau à main.
- N'utilisez pas cet accessoire pour faire levier.
- Vérifiez toujours que sa température est supérieure à 32° F (0° C) avant de vous en servir. Chauffez l'accessoire au besoin.
- Notez que l'acier d'outillage peut se casser lors de son utilisation. Tenez-vous à distance et veillez à maintenir un appui stable et équilibré.
- Ne touchez pas l'accessoire ou toute partie de l'outil à percussion proche de l'accessoire pendant ou immédiatement après son fonctionnement.

Vous pourriez vous brûler. Vous pouvez télécharger les manuels de sécurité des produits Ingersoll Rand à l'adresse suivante : www.irtools.com. Transmettez toutes vos demandes au bureau ou au distributeur Ingersoll Rand le plus proche.

SPANISH

Descripción del producto

Esta pieza de acero se diseñó para su utilización con herramientas de percusión neumática. La palabra «accessorio» se utiliza a continuación para referirse a esta pieza de acero.

ADVERTENCIA

El hecho de hacer caso omiso a las advertencias siguientes podría ocasionar lesiones.

Ponga esta información de seguridad a disposición del usuario.

- Lea detenidamente todos manuales y las advertencias que se suministran con las herramientas y accesorios.
- Corte siempre el suministro de aire, purgue la presión de aire y desconecte la manguera de suministro de aire antes de instalar, desmontar o ajustar este accesorio.
- Revise el accesorio en busca de irregularidades como grietas, fracturas, desgaste excesivo o corrosión. No utilice el accesorio si descubre cualquier signo de estas irregularidades.
- Utilice siempre el equipo de protección individual que corresponda al accesorio utilizado y al material con el que se trabaja. Esto puede incluir una mascarilla contra el polvo u otro aparato de respiración, gafas de seguridad, tapones para los oídos, guantes, delantal, zapatos de seguridad, casco y otros artículos.
- El accesorio no está diseñado para su utilización en ambientes explosivos ni cerca de peligros eléctricos.
- No toque el accesorio con las manos ni con el cuerpo mientras esté en uso. No utilice estos accesorios como cinceles de mano ni los golpee con un martillo manual.
- No utilice este accesorio para hacer palanca.
- Asegúrese siempre de que la temperatura del accesorio esté por encima de 32° F (0° C) antes de utilizarlo. Caliente el accesorio si es necesario.
- La pieza de acero se puede romper durante su utilización. Despeje la zona circundante y mantenga una postura firme y equilibrada.
- No toque el accesorio o las partes de la herramienta percutora próximas al accesorio durante o inmediatamente después de su uso. Se podrían producir quemaduras.

Los manuales de seguridad de las herramientas de Ingersoll Rand pueden descargarse de www.irtools.com. Remita todas las comunicaciones a la oficina o distribuidor de Ingersoll Rand más cercano.

ITALIAN

Descrizione del prodotto

Questo acciaio per utensili è stato progettato per l'utilizzo su utensili a percussione pneumatica. Il termine "accessorio" qui utilizzato si riferisce a questo acciaio per utensili.

AVVERTIMENTO

L'inosservanza delle seguenti avvertenze può causare lesioni fisiche agli operatori.

Tenere le presenti informazioni di sicurezza a portata di mano dell'utente.

- Leggere e accertarsi di aver compreso tutte le avvertenze e i manuali in dotazione con l'utensile e gli accessori.
- Disattivare sempre l'alimentazione dell'aria, fare sfogare la pressione dell'aria e staccare il tubo flessibile di alimentazione dell'aria prima di installare, rimuovere o regolare l'accessorio.
- Ispezionare l'accessorio per controllare che non vi siano difetti quali crepe, fratture, usura eccessiva o corrosione. Non utilizzare se si rilevano tracce di irregolarità.
- Utilizzare sempre protezioni personali adeguate all'accessorio adoperato e ai materiali su cui si intende lavorare. Può essere necessario indossare maschere antipolvere o altri dispositivi di protezione delle vie aeree, occhiali di sicurezza, cuffie, guanti, tute, scarpe antinfortunistiche, caschi ed equipaggiamento di tipo diverso.
- Questo accesorio non è adatto all'utilizzo in atmosfere potenzialmente esplosive, né in aree soggette a rischi di natura elettrica.
- Mentre è in funzione, non toccare l'accessorio con le mani o altre parti del corpo.
- Non usare mai questi accessori come scalpelli manuali, né colpirli con un martello operato manualmente.
- Non usare l'accessorio per fare da leva.
- Accertarsi che la temperatura dell'accessorio sia al di sopra dei 32° F (0° C) prima di metterlo in funzione. Riscaldare l'accessorio, se necessario.
- L'acciaio da utensili potrebbe spezzarsi durante l'uso. Tenere libero lo spazio attorno all'utensile e mantenere una posizione ben equilibrata e salda.
- Non toccare l'accessorio o le parti dell'utensile a percussione che sono vicine all'accessorio durante subito dopo il lavoro. Si può andare incontro a ustioni.

È possibile scaricare i manuali sulla sicurezza degli utensili Ingersoll Rand dal sito www.irtools.com. Per qualsiasi comunicazione, rivolgersi all'ufficio o al distributore Ingersoll Rand più vicino.

DUTCH

Produktbeschreibung

Dieser Werkzeugstahl wurde für den Gebrauch in Druckluft-Schlagwerkzeugen entwickelt. "Zubehör" bezieht sich im Nachfolgenden auf diesen Werkzeugstahl.

ACHTUNG

Das Nichtbefolgen der folgenden Achtungshinweise kann zu Verletzungen führen.

Diese Sicherheitsinformation sind dem Benutzer zugänglich machen.

- Lesen und verstehen Sie alle Achtungshinweise und Handbücher, die mit dem Werkzeug und dem Zubehör geliefert werden.
- Stellen Sie immer, wenn dieses Zubehör an- oder abgebaut oder eingestellt wird, die Luftzufuhr ab, lassen den Luftdruck ab und trennen den Versorgungsschlauch vom Werkzeug.
- Das Zubehör auf Zeichen von Unregelmäßigkeiten wie Risse, Brüche, übermäßigen Verschleiß oder Korrosion prüfen. Bei Auftreten solcher Unregelmäßigkeiten das Zubehör nicht verwenden.
- Verwenden Sie immer die persönliche Schutzausrüstung, die dem Zubehör und den bearbeiteten Materialien entspricht. Dies kann die Verwendung einer Staubmaske oder eines Atemschutzgeräts, von Schutzbrillen, Ohrstöpseln, Handschuhen, einer Schürze, Sicherheitsschuhen, eines Schutzhelms oder anderer Ausrüstung beinhalten.
- Das Zubehör wurde nicht für die Verwendung in explosiven Umgebungsbedingungen oder bei einer Gefährdung durch Strom entwickelt.
- Dieses Zubehör bei Gebrauch nicht mit den Händen oder anderen Körperteilen in Kontakt bringen.
- Dieses Zubehör nie als Handmeißel verwenden oder mit einem Handhammer schlagen.
- Das Zubehör nicht als Hebel verwenden.
- Immer sicherstellen, dass die Temperatur des Zubehörs vor der Verwendung bei über 32° F (0° C) liegt. Das Zubehör wenn nötig erwärmen.
- Ein Werkzeugstahl kann bei Gebrauch brechen. Halten Sie sich fern, balancieren Sie den Körper gut aus und sorgen Sie für einen festen Stand.
- Das Zubehör oder die schlagenden Teile des Werkzeuges nahe dem Zubehör während des Betriebes oder kurz danach nicht berühren. Verbrennungen könnten die Folge sein.

Ingersoll Rand Handbücher zur Werkzeugsicherheit können unter www.irtools.com heruntergeladen werden. Führen Sie jedwede Kommunikation über das nächste Ingersoll Rand-Büro oder eine entsprechende Werksvertretung.

Don't see what you're looking for?

Call (866) IR4-TOOL

Warranty

Ingersoll Rand construction tool steels and accessories are guaranteed against defects in workmanship and material. Products that have been misused or modified, or that have not had the proper care and maintenance, will not be considered for warranty. Our liability for warranty claims is limited to the replacement of defective product. No other warranty is expressed or implied.

Ingersoll Rand Accessories

Ingersoll Rand offers a full line of top-quality accessories specifically designed to complement our entire product offering. Any manufacturer can provide equipment or aftermarket accessories, but Ingersoll Rand offers a 360-degree, total solutions approach to everything that we do and provide.

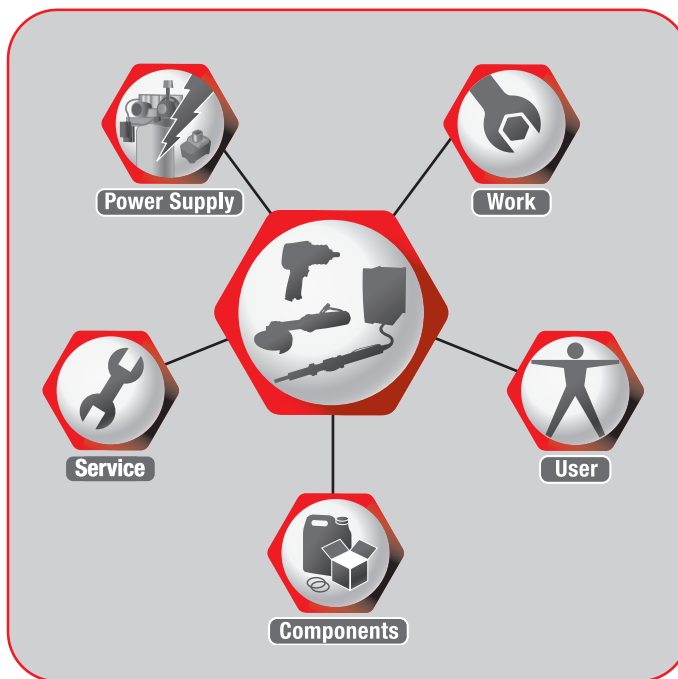

- **Power supply accessories:**
Compressor accessories, couplers and connectors, fittings and hoses, FRLs, etc.
- **Work accessories:**
Sockets, tool steels, abrasives and surface prep accessories, sanding and polishing pads, carbide grinding burs, etc.
- **User accessories:**
Gloves, spring balancers, tool boots, comfort grips, etc.
- **Components:**
Lubricants, repair kits, etc.

For more information visit our Web site irtools.com, order the Ingersoll Rand Accessories Catalog (form #IR-0605-097), or call (800) 376-TOOL.

Distributed by:



Ingersoll Rand Industrial Technologies provides products, services, and solutions to enhance the efficiency and productivity of our commercial, industrial, and process customers. Our innovative products include air compressors, air systems components, tools, pumps, material and fluid handling systems, and microturbines.

(866) IR4-TOOL · irtools.com